

Parts

- (A)** CPU Cooler
- (B)** Intel LGA 1366 Mounting Kit
- (C)** Intel LGA 775 Mounting Kit
- (D)** AMD Mounting kit
- (E)** Screws

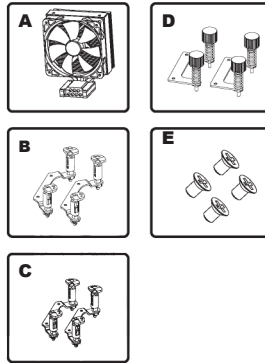

Airflow Direction

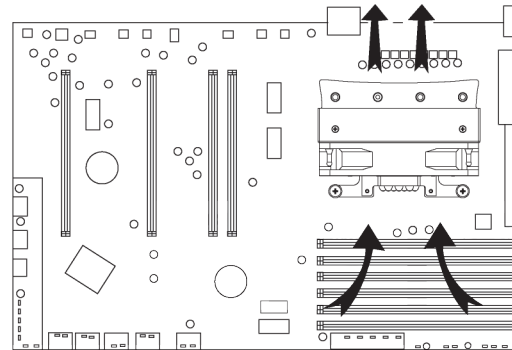

Contact

Dynatron Corp. Headquarters
 41458 Christy Street, Fremont, CA 94538
 +1 (510) 498-8888 Main Phone

Dynatron LA Office
 337 Paseo Sonrisa, Walnut, CA 91789
 +1 (909) 598-2222 Main Phone

Dynatron Taiwan office
 8F, No. 35, Lane 221, Gang-Chian Rd,
 Nai Hu, Taipei 114, Taiwan R.O.C.
 +886 (02) 27995799 Main Phone

Website :
<http://www.dynatron-corp.com/>

Install step

Intel LGA 1366

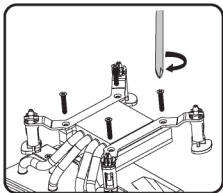

Assemble the Intel LGA 1366 **(B)(E)** retention bracket mounting kit

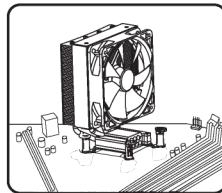

Secure the CPU cooler **(A)** to the motherboard

AMD

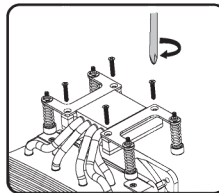

Assemble the AMD AM2/AM2+/AM3 retention bracket mounting kit **(D)(E)**.

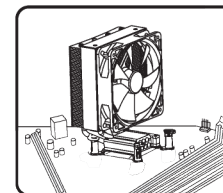

Secure the CPU cooler **(A)** to the motherboard

Intel LGA 775

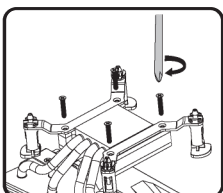

Assemble the Intel LGA 775 **(C)(E)** retention bracket mounting kit

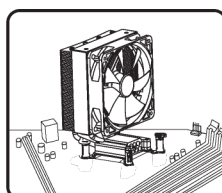

Secure the CPU cooler **(A)** to the motherboard

Connect Fan Cable

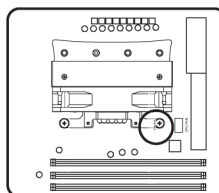

Connect the PWM function fan to the motherboard.